

5		6		7		8	
Model No		Working pressure		Working Temperature		Dimension(mm)	
4872		150psi(10.5BAR)		1-49centigrade		∅ 1200x2100	
Top Opening		Bottom Opening		Water flow rate		Volume	
6"-flange		6"-flange		22.0~27.0{ TPH}		1748Liters	
				Net H		Total H	
				1820		2100	

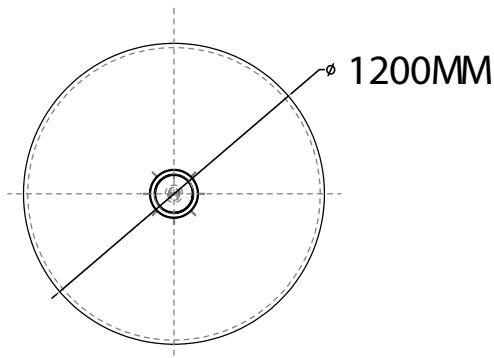

Top-Bottom View

- NOTES:
- TANK MUST MEET ALL APPLICABLE SPECIFICATIONS OF NSF/ANSI 044 STANDARD, LATEST REVISION.
  - OPERATING SPECIFICATIONS:
    - A. MAXIMUM WORKING PRESSURE - 150 PSI (10.5BAR)
    - B. TEMPERATURE RANGE - 34-120° F (1-49°C)
    - C. MAXIMUM VACUUM - 5"Hg (127mm Hg)
  - VISUAL LINER INSPECTION
    - A. NO MORE THAN 10 INTERNAL OR EXTERNAL BLEMISHES OR BURNT DEBRIS.
    - B. NO INTERNAL OR EXTERNAL BLEMISHES OR BURNT DEBRIS LARGER THAN 3×3mm.
    - C. NO INTERNAL BLEMISHES OR BURNT DEBRIS ALLOWED.
  - ALL GLASS STRANDS FROM FIBERGLASS LINER TO BE BONDED AND COVERED.
  - [5]. SURFACE TO BE FREE OF NICKS, SCRATCHES, RESIN AND GLASS.
  - [6]. SURFACE FINISH.
  - DIMENSIONS IN PARENTHESIS ARE REFERENCE ONLY.
  - DIMENSIONS IN SQUARE PARENTHESIS ARE INCH UNIT.
  - USING A STANDARD LEVEL WITH TANK POSITIONED ON A LEVEL SURFACE, DATUM-B TO BE PARALLEL WITH DATUM A. BUBBLE OF LEVEL MUST FALL COMPLETELY WITHIN LINES WHEN MEASURED AT 90° INTERVALS.

VERSION NO.		DESCRIPTION OF CHANGES:			
REFERENTIAL PLASTIC SHRINKAGE (IF NECESSARY):		MODEL: FT 4872			
SIGNATURE					
NAME	DATE				
DESIGN		SCALE	MATERIAL	MODEL	
INSPECTION				DESCRIPTION	
APPROVAL		QUANTITY	SMOOTHNESS	FRP PRESSURE VESSEL	
THIS PRODUCT DRAWING CAN NOT BE COPIED AND/OR USED WITHOUT PRIOR WRITTEN APPROVAL OF WAVE CYBER.		PROJECTION	COMPUTER CODE		
DO NOT MEASURE THE DIMENSIONS			UNIT: MM	TOTAL PAGE: 1	